

REV.	SPECIFICATION	ECN NO.	APPD.
R8			

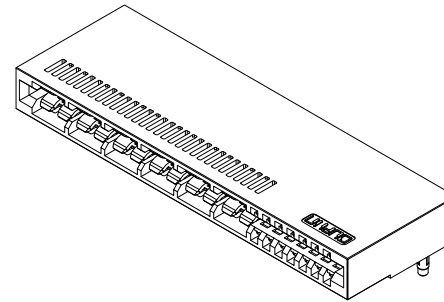
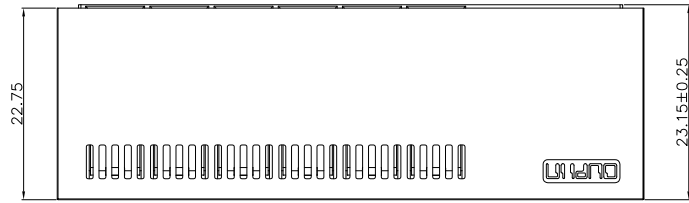

**Material and Plating:**

Housing: LCP, UL94V-0, Black.  
 Power Contacts: High Conductivity Copper.  
 30u"Au+Pd/Ni on Contact Area and 80u" Min Tin Plated on Solder Tail over nickel 50u" Min .  
 Signal Contacts : Phosphor Bronze.  
 30u"Au+Pd/Ni on Contact Area and 80u" Min Tin Plated on Solder Tail over nickel 50u" Min .

**Electrical Characteristics:**

Current Rating: Signal Pin 3.0 A(UL).  
 Power Pin 55 A(UL).  
 Insulator Resistance:  
 Signal Pin 500MΩ min. at DC 500V.  
 Power Pin 5000MΩ min. at DC 500V.  
 Dielectric Withstanding Voltage:  
 Signal Pin DC 500V For 1 minute.  
 Power Pin DC 1000V For 1 minute.  
 Contact Resistance: Signal Pin 25mΩ max.  
 Power Pin 0.6mΩ max.  
 Operating Temperature: -55°C ~+105°C .

**\*RoHS Compliant**

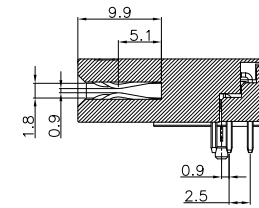
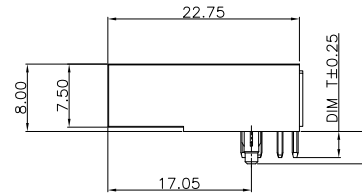
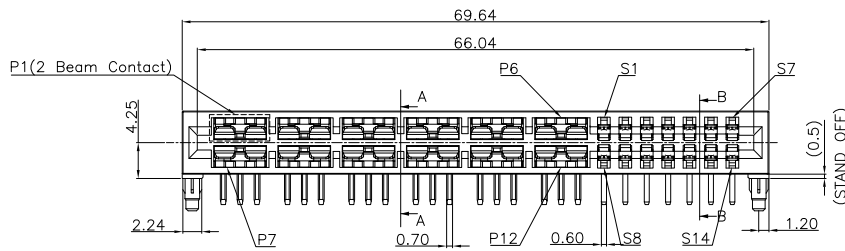

Section: B-B

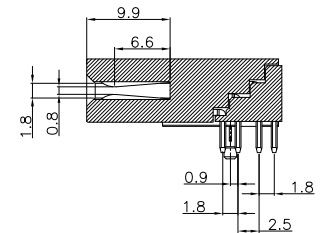

Section: A-A

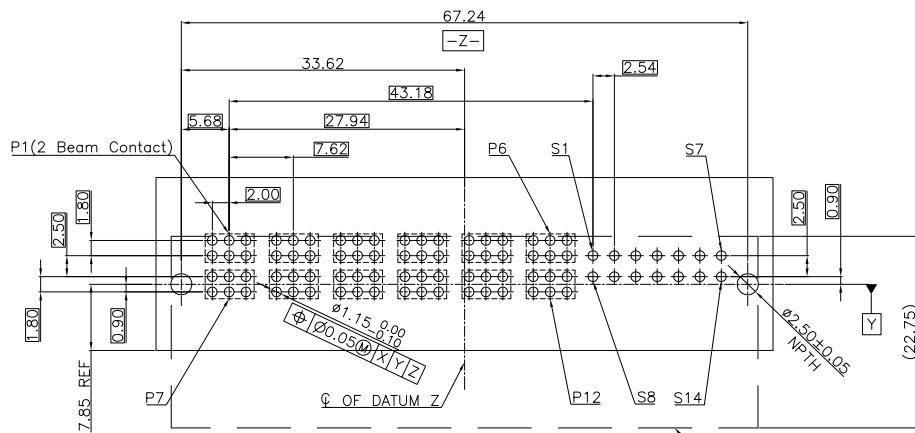

P.C. Board Layout(Top View)  
 (Tolerance:±0.05)

OUTLINE OF CONNECTOR

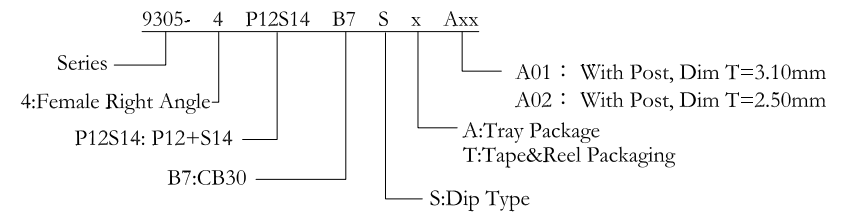
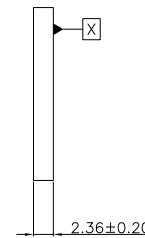

Tolerances	Dwg. No.	9305-DP12S14-001	Title:
x = ±0.5	Projection		9305 Series
.x = ±0.25	Unit	mm	High Power and Signal
.xx = ±0.15	Scale	1:1	Edge Card Connector
	Drawn By	WP 09/18'23	

<b>OUPIN</b>			
OUPIN ELECTRONIC(KUNSHAN) CO., LTD.			
P/N: 9305-4P12S14B7SxAxx			
SHEET	1/2	Ver.No.	R8

REV.	SPECIFICATION	ECN NO.	APPD.
R8			

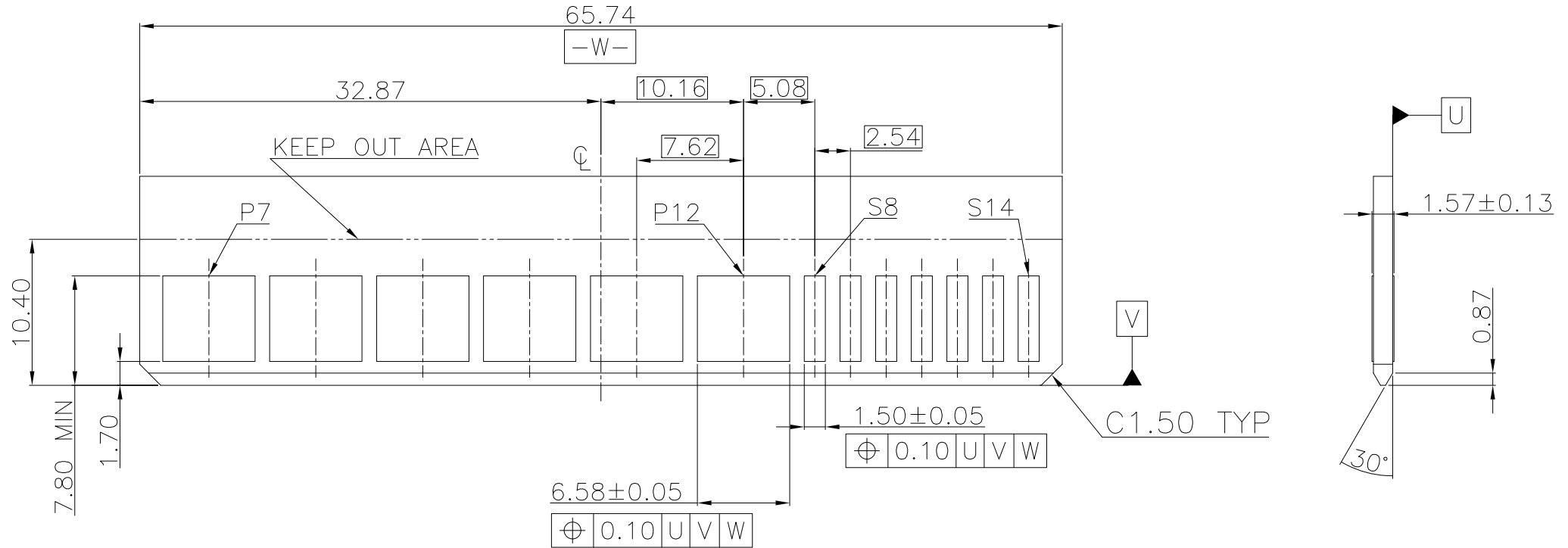

**Recommended Edge Card Layout**  
(Tolerance: ±0.05)

Tolerances	Dwg. No.	9305-DP12S14-001		Title:	
x = ±0.5	Projection			9305 Series High Power and Signal Edge Card Connector	
.x = ±0.25	Unit	mm	Scale		1:1
.xx = ±0.15	Drawn By	WP 09/18'23			

Title:			
9305 Series High Power and Signal Edge Card Connector			

OUPIIN ELECTRONIC(KUNSHAN) CO., LTD.			
P/N: 9305-4P12S14B7SxAxx			
SHEET	2/2	Ver.No.	R8