

REV.	SPECIFICATION	ECN NO.	APPD.
R3		ECN230309	

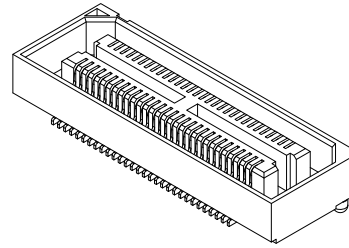
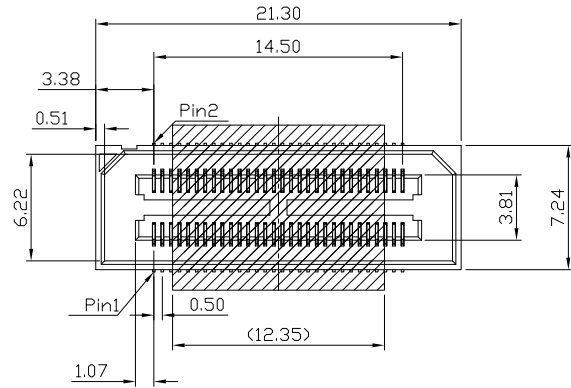

**Material and Plating:**

Housing: LCP, UL94V-0, Black.

Signal Contacts :Phosphor Bronze.

Gold Plated on Contact Area and 80u" Min Tin Plated on Solder Tail over nickel 50u" Min .

Lock : Brass

80u" Min Tin Plated over nickel 50u" Min .

**Electrical Characteristics:**

Current Rating: Signal: 3A Per Contact With 3 Adjacent Contacts (UL).

Voltage Rating: 125V AC .

Dielectric Withstanding Voltage: 525V AC For 1 minute.

Insulator Resistance: 5000MΩ min at DC 500V.

Contact Resistance: 45mΩ max .

Operating Temperature: -55°C ~ +125°C .

**\*RoHS Compliant**

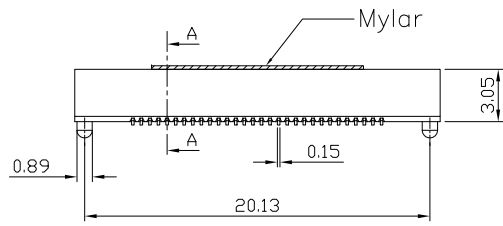

P: With Post Option Shown

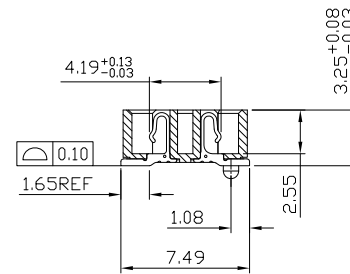
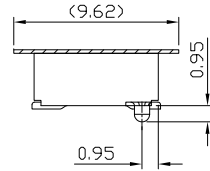

Sectional A-A  
Scale 1:1

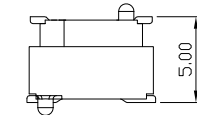

Mating Height

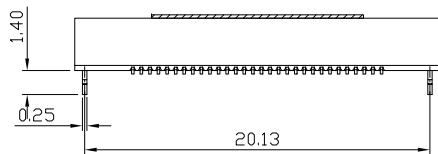

L: With Lock Option Shown

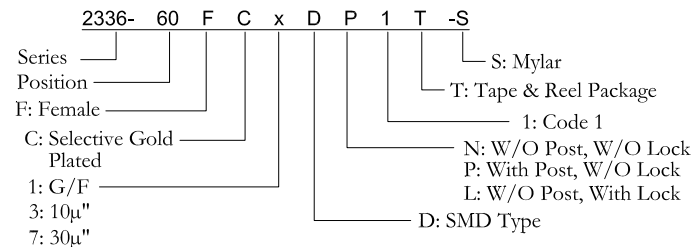
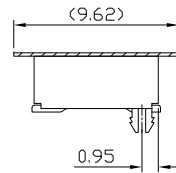

Tolerances	Dwg. No.	2336-D0000-001	Title:		2336 Series		<b>OUPIN</b> OUPIN ELECTRONIC(KUNSHAN) CO., LTD.		
x = ±0.5	Projection		High Speed Board to Board		Pitch 0.5mm (Receptable)				
.x = ±0.25	Unit	mm	Scale	1:1		P/N: 2336-60FCxDPT-S			
.xx = ±0.15	Drawn By	WP 03/09'23			SHEET		1/2	Ver.No.	R3

REV.	SPECIFICATION	ECN NO.	APPD.
R3		ECN230309	

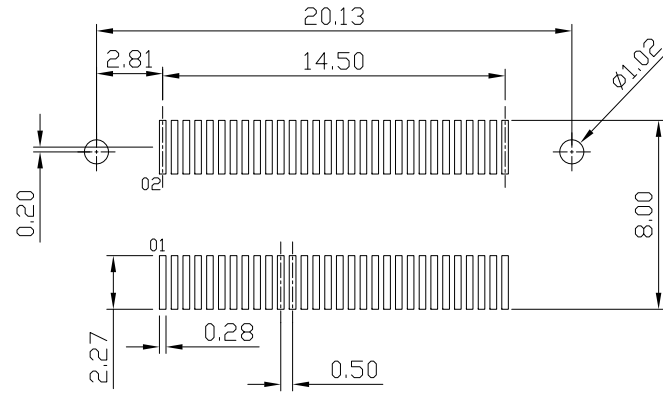

P.C.Board Layout For P Options  
(Tolerance:  $\pm 0.05$ )

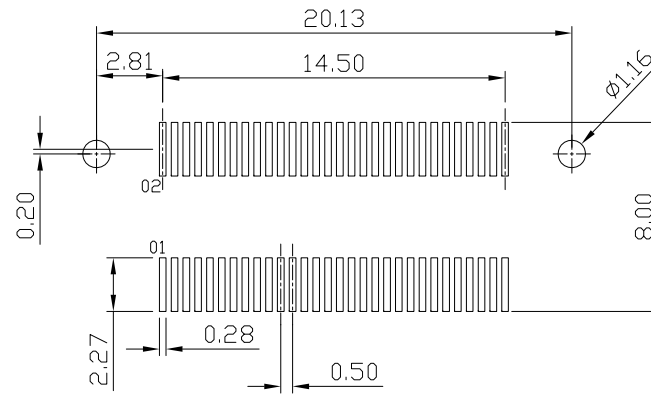

P.C.Board Layout For L Options  
(Tolerance:  $\pm 0.05$ )

Tolerances	Dwg. No.	2336-D0000-001	Title:		 <b>OUPIIN ELECTRONIC(KUNSHAN) CO., LTD.</b> P/N: 2336-60FCxDP1T-S			
x = $\pm 0.5$	Projection		2336 Series					
.x = $\pm 0.25$	Unit	mm	Scale	1:1	High Speed Board to Board			
.xx = $\pm 0.15$	Drawn By	WP 03/09'23	Pitch 0.5mm (Receptable)		SHEET	2/2	Ver.No.	R3